

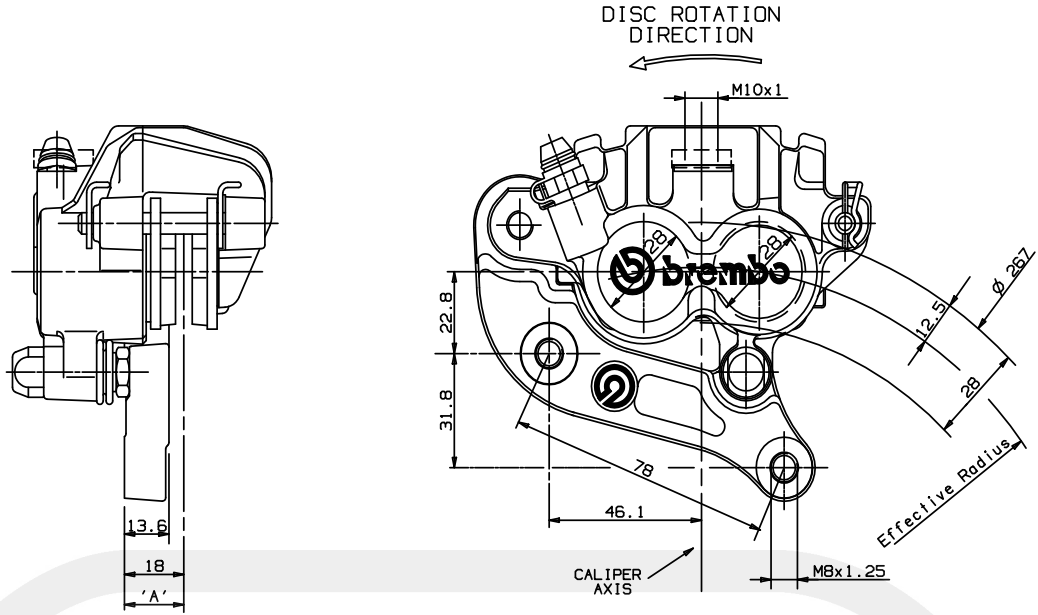

FLOATING CALIPER

| |
|---------------------|
| PF 2x28 D |
| 22.5930.50 A |



DESCRIPTION

Floating caliper with 2 pistons.
 Caliper's body slides on one bracket.
 Pads are supported by one pin and one bracket.
 Construction Material: Aluminium Alloy.
 Operating fluid: brake fluid DOT4.

N.B.: drawing shows left side caliper.
 Mounting side behind the fork.

PADS SHAPE AND DIMENSIONS

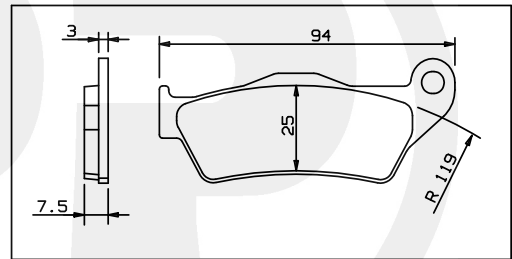

TECHNICAL CHARACTERISTICS

| | | | |
|-------------------------------|-----------|----------------------------------|----------------------|
| Pistons number and diameter: | 2 28/28mm | Average pad surface (1 pad): | 16.9 cm ² |
| MAX working pressure: | 70bar | Weight (with not sintered pads): | 0.745 Kg |
| A) Disc position (TOLERANCE): | ±0.6 mm | | |
| Usable disc diameter: | 267 mm | | |

CONFIGURATION

| CHARACT. CODE CALIPER | PADS FRICTION MATERIAL | BODY COLOR | BRACKET COLOR | MOUNT. SIDE | USABLE DISCS THICKNESS | BRAKE FLUID FOR PADS WEAR |
|-----------------------|------------------------|------------|---------------|-------------|------------------------|---------------------------|
| 22.5930.50 | FERIT I/D 450 FF | NATURAL | NATURAL | SX | 4.0 mm | 10.22 cm ³ |

AVAILABLE SPARE PARTS

| SPARE PARTS CODE CALIPER | PADS | BLEEDER SCREW | DUST COVER | BOOTS | PIN/RETAINER | SPRING/STEEL CLIP |
|--------------------------|-------------|---------------|-------------|-------------|--------------|-------------------|
| 22.5930.50 | 107.5269.11 | 105.3387.60 | 105.1502.20 | 122.4746.14 | 122.5089.21 | 120.4683.20 |

Indicating informations subject to modification.
 For further specifications contact Technical Section.

LAST UPDATE: 30/05/1996